

# Weld-On Lifting Hooks

Introducing two weld-on hooks from CM Industrial Products

Designed for welded attachment to front end loaders or other mobile lifting/excavation equipment. Other uses include lifting beams and spreader bars.

## JD Weld-On Alloy Lifting Hook

- Designed so the latch will never carry load when used under normal conditions.
- Heavy duty forged latch interlocks with hook tip.
- Large weld pad on forged alloy steel hook.
- Trace code forged into each hook.
- Detailed welding instructions included with each hook.
- Available working load limit from one to ten tons.
- Hook design allows easy sling hook up.
- Thumb tab on latch for convenient sling removal.
- Sling eye can be attached to hook by "slip and pull" method.
- Each hook forged with load marks to assist user in locating correct load zone.

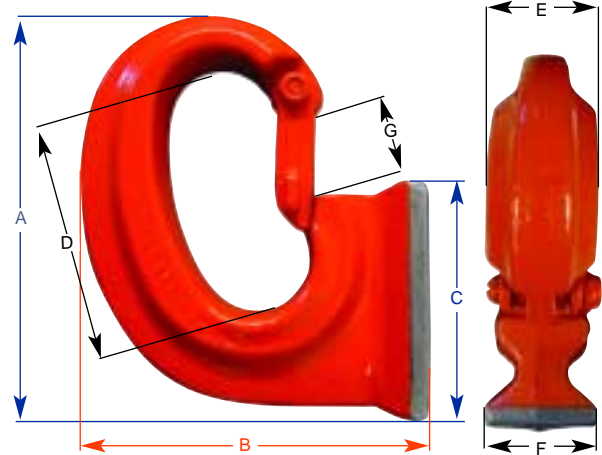

Product Code	Dimensions (inches)							Working Load Limit (Tons)	Working Load Limit (Lbs.)	Approx. Wt. Ea. (Lbs.)
	A	B	C	D	E	F	G			
M4301	4.750	4.134	2.781	2.930	1.000	1.250	0.840	1	2,205	2.2
M4303	5.984	4.719	3.743	3.340	1.250	1.297	0.980	3	6,615	4.6
M4305	8.228	6.509	5.120	4.861	1.156	1.719	1.788	5	11,025	7.5
M4310	11.306	8.457	6.937	7.050	1.781	2.469	1.980	10	22,050	22.5

Design factor 5:1.

## Yale Import Weld-On Lifting Hook

- Heavy duty forged latch interlocks with hook tip.
- Large weld pad on forged steel hook.
- Each hook has full traceability.
- Detailed welding instructions included with each hook.
- Available working load limit from one to eight tons.
- Thumb tab on latch for convenient sling removal.
- Manufactured in China by a division of Columbus McKinnon Corporation.

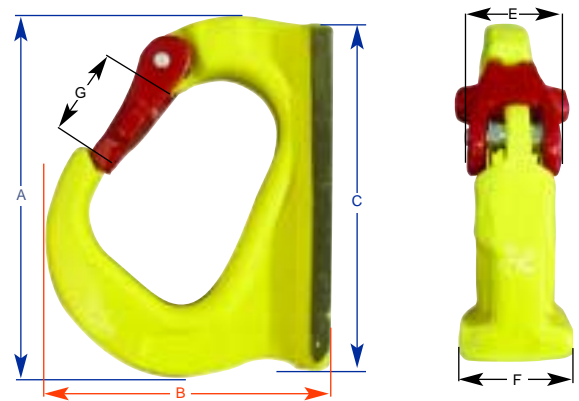

Product Code	Dimensions (inches)						Working Load Limit (Tons)	Working Load Limit (Lbs.)	Approx. Wt. Ea. (Lbs.)
	A	B	C	E	F	G			
48211	3.859	2.992	3.543	0.669	0.984	0.945	1	2,205	0.9
48212	5.406	4.134	5.118	0.945	1.378	1.142	3	6,615	2.9
48213	6.750	5.197	6.299	1.181	1.772	1.457	5	11,025	5.3
48214	7.641	5.433	6.693	1.575	1.969	1.850	8	17,640	8.5

Design factor 4:1



AMHERST, NEW YORK 14228-1197  
 TEL: 800/888-0985 • 716/689-5400  
 FAX: 716/689-5644

[www.cmindustrial.com](http://www.cmindustrial.com)

**WARNING** Do not use for lifting people or loads over people. To avoid injury:

- Welding to be done only by qualified welder.
- Follow welding instructions included with each hook.
- If instructions are missing, contact Columbus McKinnon, 800-888-0985.